



SAINT GEORGE CATHOLIC COLLEGE

Year 7 Pupil Induction Booklet 2026-2027



<u>Table of contents:</u>	
Welcome	3
ASPIRE Values	4
Meet your progress leader	5
Other importance faces	6
Subjects	9
Tutor time	10
Planners	11
Equipment/The Term	12
The School Day	13
Clubs	14
Map of the school	15
Pictures of the school	16
Expectations	19
Behaviour/House Points	20
Trinity	22
Lunch time	24
Lockers	25
EduLink and MS Teams	26
The school website	27
Frequently Asked Questions	38

Welcome

A very warm welcome to St George Catholic College. The transition to secondary school is an exciting time but it can be worrying, and you may have lots of questions about your new school. We hope this booklet may answer some of them for you, and help to give you an introduction to life at St George.

At St George, we pride ourselves on being not just a school but a family; your teachers are there to not only help you gain your GCSEs by the time that you leave us, but to help you become life-long learners and give you all of the opportunities possible to be a happy and successful adult in the future.

In this booklet you will find information about our school expectations and routines and there will be some Frequently Asked Questions at the end that hopefully answer anything you want to know about the school.

We look forward to seeing you in September.

ASPIRE values:

At St George we follow our 'ASPIRE' values. These help us to be the best version of ourselves every day. We expect students to strive to achieve both in their lessons and their hobbies, to be spiritual and support our Catholic ethos, to show respect to everyone in school, to be independent in their work and choices and to form positive relationships with other students and staff members. By doing this, everyone will enjoy their time at St George.



Think about how you show the ASPIRE values in your everyday life:

Achievement - are there any subjects you thrive in? Do you have any hobbies you're good at? Is there anything new you would like to try when you arrive at St George?

Spirituality - are there any religious practices you currently take part in? Do you attend church regularly and contribute to your local community?

Respect - do you show respect to your family, friends, teachers? Could you find a way to help them and be kind to them to show your respect?

Independence - Do you try your best to do your classwork and homework independently? Have you been independent outside of school, like joining a club and working hard at it without being told to?

Relationships - How do you make sure that you have positive relationships with your friends, family, teachers?

Enjoyment - What do you enjoy? Any particular subjects or hobbies? Think about what new clubs you could join at St George.

Your Progress Leader/Tutor:

Your Progress Leader is in charge of the year group. Their most important job is to make sure everyone in the year is feeling safe, secure and happy. They also monitor the progress of the year group so that they can help students who are finding their work difficult, as well as congratulate those who do excellent work. Your Progress Leader is one of the members of staff you can go to if you have a problem. Your Progress Leader will be Mr Copplestone. "I'm very much looking forward to working with you in the future. Welcome to the St George Family!"



Your tutor is going to be a very important person in your St George life. They will be the first teacher you see every day and you will spend twenty minutes each morning in tutor time. They will also teach you PSHE once a week for an hour. If you ever have any problems, your tutor should be one of the first people you go to, they are there to help you with academic issues, but even more importantly, any social or emotional issues too.

Other important people:



Mr Habberley
Headteacher & Deputy
Safeguarding Officer

A warm welcome to Saint George Catholic College. I am Mr Habberley your headteacher. I am looking forward to seeing you all very soon and supporting you as you settle into our wonderful family. If I can give you any advice be the best version of yourself, demonstrate our ASPIRE values and focus on all the exciting opportunities secondary school will bring.

when Mr Coplestone and I came to visit some of your primary schools. I'm in charge of supporting you with your transition from primary to secondary school, so if you need any extra help when you join us in September please let me know!



Mrs Provenzano
Transition Lead

Hi everyone, I hope you are well. I am looking forward to meeting you all. Pray and ask God to help you over the summer and for a good start to the term. Remember He loves you!



Mr Walford
Chaplain & Senior
Leader



Miss Cordeiro
Designated
Safeguarding Lead &
Deputy Headteacher

Welcome to St George! We look forward to meeting you. I am in charge of behaviour and safeguarding in our school. This means my job is to make sure everyone is able to learn in a safe, healthy and positive environment so that everyone can achieve their best, but also enjoy their time in school.

A warm welcome to St George from myself and the staff team in Trinity, which is the school student support service. Our team are on hand to help students with any issues, concerns or worries they have to ensure they love coming to St George as much as we do! Never forget that 'a problem shared is a problem half solved'!



Mr Guyer
SENCO & Assistant
Headteacher



Mrs Odam
Attendance Officer

Welcome to St George! I am the attendance officer. If you are ever late for school you must come to my office so that I can sign you in. I will also be in close correspondence with your parents, especially about your attendance.

Hi, I'm the Medical Welfare Officer for the school. I am a qualified children's nurse and my role is to look after you if you become unwell, have an accident or already live with a long-term condition. I am based in the medical room and my door is always open.



Mrs Chappell
Medical Welfare
Officer

Subjects:

Secondary school has lots of new and exciting subjects that you may have never studied at primary school, as well as the subjects you will be used to learning. This is an opportunity for you to discover new interests. You will study:

- English
- Maths
- Science
- Religious Education
- History
- Geography
- Modern Foreign Language (French or Spanish)
- Drama
- Dance
- Music
- Art
- Design & Technology (including Food Tech)
- PE
- PSHE (Personal, Social and Health Education)

Tutor time:

Here is an example of what tutor time can look like...

8.30-9.00am		
Monday	Newsround / current issues Equipment check	Students will watch Newsround or discuss current issues. Tutor will check your equipment.
Tuesday	Assembly	Different themes each week, students will line up outside of the hall rather than go to tutor.
Wednesday	Literacy	Word of the Week activities. Tutor group will read a book together.
Thursday	Numeracy	Numeracy Ninjas
Friday	Spirituality	Our chaplain will send an informative, spiritual PowerPoint each week where students will learn about different saints and elements of our Catholic faith.

The role of your tutor:

- Your tutor is the first point of contact for you and your parents. If you have any worries or concerns, you should speak to them.
- They will lead morning prayers and reflection time.
- They enforce our school expectations, such as checking that your planners, uniform and equipment are following our policies.
- They will monitor your behaviour; this means giving rewards and sanctions when necessary.
- They will monitor your progress and attainment across your subjects and every term they will meet with you and your parents to discuss this during a 'mentoring day'.

Planners:

Your planner is very important in Secondary School, it is what helps to keep you organised with all of your new subjects and teachers. It is used for the following:



- Writing in your homework and when it is due.
- Having a copy of your timetable.
- Recording if and when you have any detentions.
- Teachers will give you uniform strikes in your planner if you're not following the uniform policy.
- It also has a map to help you find your way around the school!

Once a half term your tutor will check your planner. Your parent/guardian needs to sign your planner each half term (although it is your responsibility to remind them!) This way they can also know if you have any homework, what you are studying, if you have any uniform strikes, and if you have any detentions from teachers.

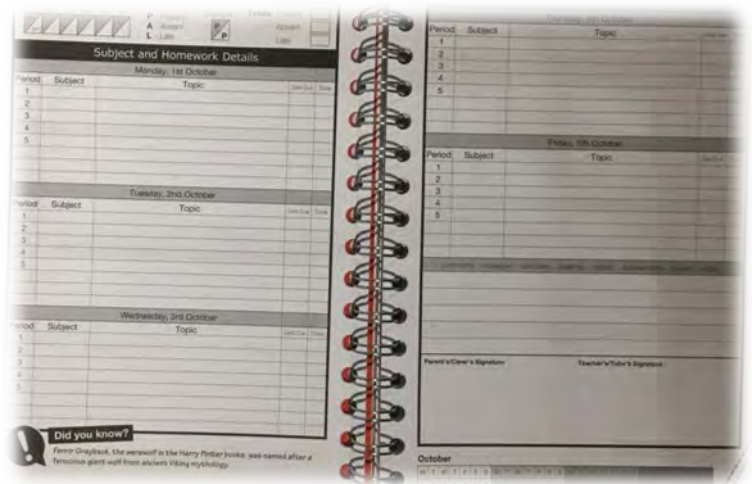

Equipment:

To support your learning, please ensure you have the necessary equipment from the start. Below is a recommended list of items that will help you succeed in lessons

- Pencil Case
- Black/Blue Pen
- Green Pen
- Pencil
- Ruler
- Rubber
- Scientific Calculator (Casio FX-83GTX recommended)

The Term:

2026-2027 term dates:

Term	Starting	Ending
Autumn one	1 September 2026	23 October 2026
Autumn two	2 November 2026	18 December 2026
Spring one	4 January 2027	12 February 2027
Spring two	22 February 2027	25 March 2027
Summer one	12 April 2027	28 May 2027
Summer two	7 June 2027	21 July 2027

2026-2027 holidays

Holiday	Starting	Ending
Autumn half-term	26 October 2026	30 October 2026
Christmas holidays	21 December 2026	3 January 2027
Spring half-term	15 February 2027	19 February 2027
Easter holidays	26 March 2027	9 April 2027
Summer half-term	31 May 2027	4 June 2027
Summer holidays	22 July 2027	31 August 2027

The school day:

Tutor Time	8.30-9.00
Lesson 1	9.00-10.00
Lesson 2	10.00-11.00
Break	11.00-11.20
Lesson 3	11.20-12.20
Lesson 4	12.20-1.20
Lunch	1.20-1.55
Lesson 5	2.00-3.00



Extra information:

- Afterschool clubs run from 3.00pm-4.00pm. There are lots of different clubs for sports, music and Performing Arts. Sports fixtures will usually finish later than these times however students will always be informed. You won't be able to get the school bus home after your club, you will need to find your own way home after agreeing a plan with your parents/guardians.
- On Monday, Wednesday, and Friday a bell will ring at 12.15pm - this is the Angelus bell, the whole school will gather in prayer and do the Angelus in their classroom at the same time.

Clubs:

Here is an example of our club list, it is expected that you join at least one club during Year 7 (either lunch time and/or after school).

Lunchtime Clubs and Activities: SPRING TERM B

MON	TUES	WEDS	THURS	FRI
Years 10 & 11 BASKETBALL Sports Hall Mr Devine <i>(Except during mock exams)</i>	Years 9-11 DRAMA R16 Miss Street	Year 7 & 8 GAMES & SOCIAL CLUB L10 Mrs Provenzano	Years 7 - 9 BASKETBALL Sports Hall Mr Gillard <i>(Except during mock exams)</i>	All Years MULTI-GYM Miss Ireland 
Years 7 & 8 SCIENCE CLUB G9 Miss Cullum	Years 7 - 9 BASKETBALL Sports Hall Mr Gillard <i>(Except during mock exams)</i>	Years 7&8 ART CLUB L3 Miss Pilcher	All Years TRINITY GAMES CLUB TR2 Trinity Staff/Miss Radzik	All Years PHILOSOPHY CLUB R13 Mrs Atkinson
All Years TRINITY GAMES CLUB TR2 Trinity Staff/Miss Radzik	All Years TRINITY GAMES CLUB TR2 Trinity Staff/Miss Radzik	Years 10 & 11 BASKETBALL Sports Hall Mr Gillard <i>(Except during mock exams)</i>	Years 7-9 LANGUAGES GAMES & EXCHANGE CLUB G2 Miss Raymont	All Years REFLECTIONS CRAFT CLUB R2 Mrs Lee-Cann/Mrs Stevens
All Years HISTORY CLUB L8 Ms Lefeuvre	All Years NEWSPAPER CLUB R3 Mr Scott	All Years TRINITY GAMES CLUB TR2 Trinity Staff/Miss Radzik	All Years THEOLOGY CLUB R5 Mr Farrell	All Years TRINITY GAMES CLUB TR2 Trinity Staff/Miss Radzik
All Years MULTI-GYM Miss Ireland 		Years 7 & 8 3D PRINTING CLUB G3 & G7 Mrs Gilbank	Years 9-11 ART WORKSHOP L4 Mrs Sumner	Years 10 & 11 BASKETBALL Sports Hall Mr Gillard <i>(Except during mock exams)</i>
Please check with the member of staff who is running the club what time you are expected to arrive by.		All Years MULTI-GYM Miss Ireland 		All Years SCIENCE FILM AND DOCUMENTARY CLUB G8 - Mrs Gibb
FRIDAY TUTOR TIME: ALL YEARS - ASPIRE VOICES – Music Department - Mr May/Mrs Pegg		All Years AFRICAN CARIBBEAN & ALLIES SOCIETY R9 - Mrs Smallwood		Years 7-9 ECO-COMMITTEE (for elected members & selected weeks) B4 Mrs Rope

After-School Clubs and Activities: SPRING TERM B

MON	TUES	WEDS	THURS	FRI
Year 10 POLISH Booster Club G4 Mrs Davenport	Years 7 & Year 8 DRAMA R16 Miss Street	All Years SG POPS L6 Mr May/Mrs Pegg	Year 10 COOKING CLUB G5 Mrs Fisher 	Year 10 DUKE OF EDINBURGH G4 Mrs Fisher / Miss Maton
	COMPUTER SCIENCE CLUB (Week A –Y7, Week B –Y8) R11 Mr Ndabala/Mrs Smallwood	All Years DANCE Club Dance Studio Miss Catley		All Years BASKETBALL CLUB Sports hall Mr Guyer & Mr Rodriguez
	All Years 3D DESIGN CLUB Mr Rodriguez G7	All Years FOOTBALL CLUB Astro PE Department		
	All Years NETBALL MUGA Miss Ireland	Years 8-11 FIRST AID CHAMPIONS R16 Mrs Chappell		
		Years 9 & 10 NEW VIEWS SCRIPT WRITING L7 Miss Templeman		Unless otherwise advertised, all after-school clubs run from 3.05pm to 4pm.

Map of the school:

We are currently undergoing some building work so the school will look slightly different when you arrive in September. You can find more images of our school on our website if you're interested.

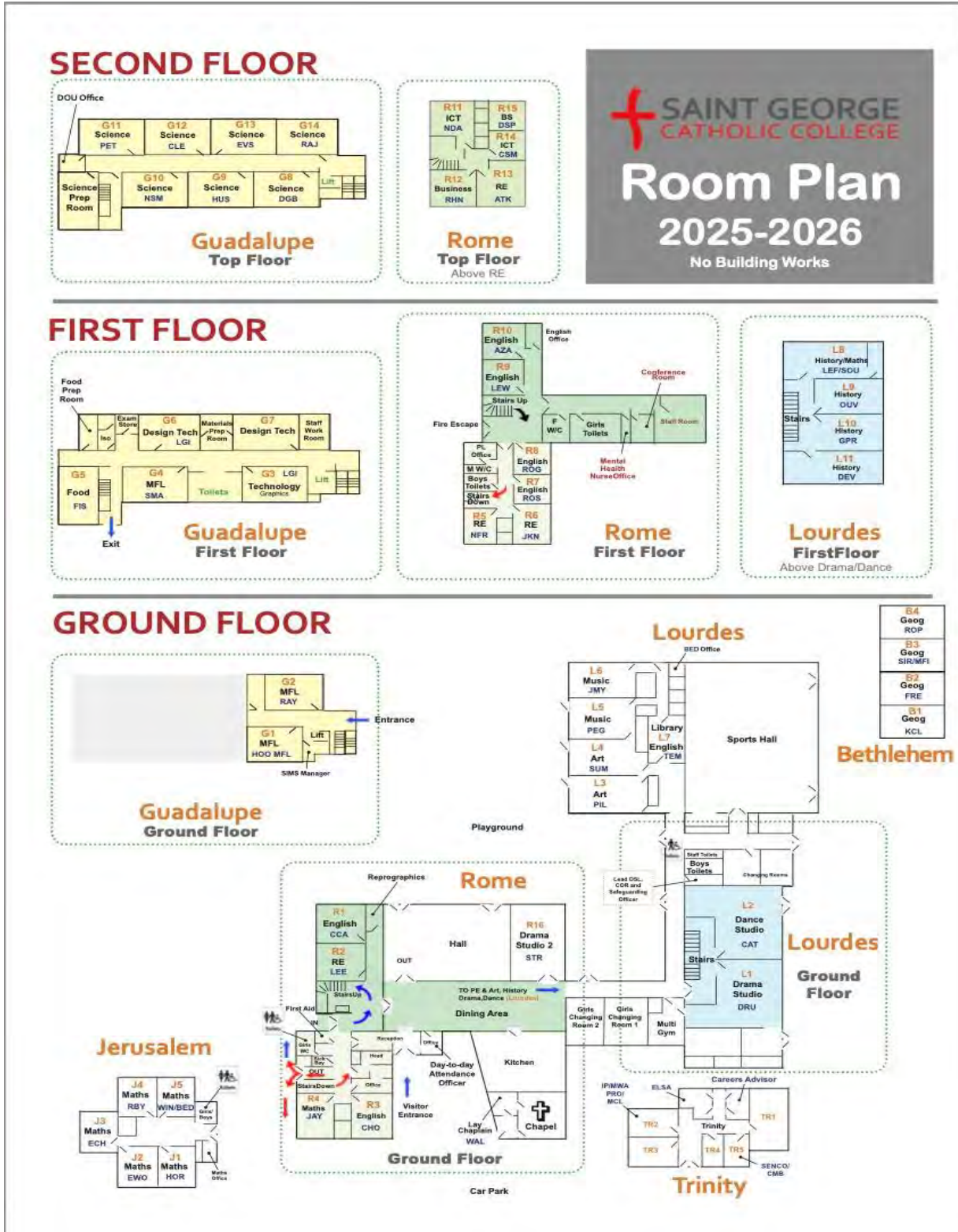

Pictures of the school:



St George has a great sense of community. Our school hall is used throughout the year for wonderful events such as Masses and reward ceremonies.





We have lots of areas for you to work hard and relax at St George.



Here are some of our fantastic P.E facilities. We have a MUGA alongside our gym, sports hall, astro-turf and field used for lessons as well as extra curricular activities.



Expectations:

Attendance:

We know that everyone gets ill and sometimes they have to miss school; however, we expect attendance to be as close to 100% as possible. You should only miss school if you absolutely have to. If you do miss school, your parent/guardian must call and tell us, and if your attendance drops to below 95%, your tutor may need to have a meeting with you and your parents/guardians.

Tutor groups with the best attendance receive rewards, as well as individual students. Having a good attendance will also allow you to go on a reward trip!

Punctuality:

Punctuality is also very important. Tutor time starts at 8.30 so please make sure that you are there on time. You must also be on time for all of your lessons, if you're late, you will get a detention that day (unless there is a good reason.)

Uniform:

Students must wear their uniform to the correct standard - this means shirts tucked in, ties long and neat, skirts appropriate length, no makeup and only one pair of stud earrings with no other jewellery. No facial piercings. In the Summer term we have a different uniform that you can purchase to help with the hotter weather, this includes a polo shirt with no tie and a jumper instead of a blazer. You will also need to buy St George PE kit. Uniform expectations can also be found in your planner.

There will be a uniform strike list in your planner, if you get three strikes for poor uniform, you'll get a detention. There are always house points for having consistently good uniform!



Behaviour:

Rewards:
If you are respectful and work as hard as you can, there are lots of rewards that the school offer...

- McDonalds trips
- Subject certificates
- Reward trips every term
- Attendance rewards
- Postcards home
- Reward evenings
- Homework rewards
- House points (individual prizes and tutor group prizes!) there's also reward hours for house points

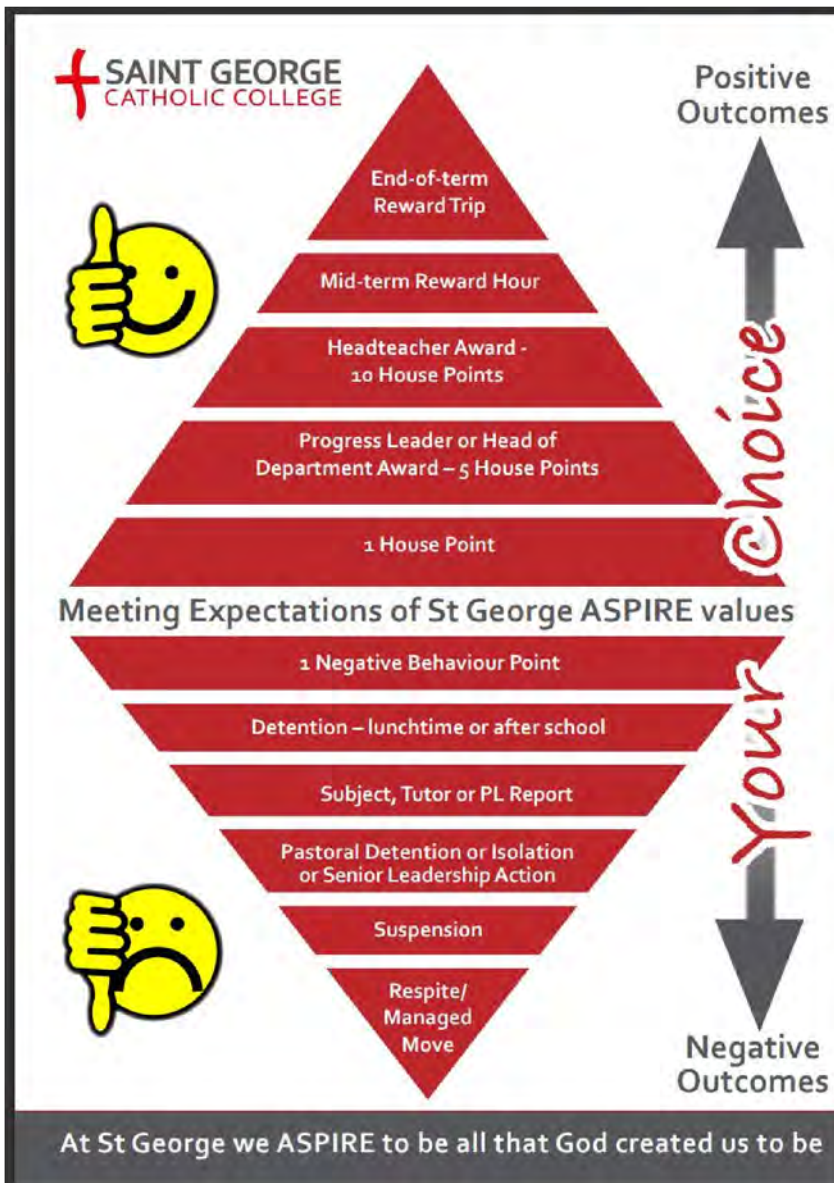

Sanctions:

This behavior chart will be in every classroom. It tells you what sanctions you receive if you do not follow our ASPIRE values. This is not just during lessons, but before and after school, at breaktime, lunchtime and when going from lesson-to-lesson.

If you behave well in class and contribute well in your lessons you can get house points, there are reward hours once a half term for students with the most house points and there are bronze, silver and gold awards when you reach milestones.

ACHIEVEMENT
SPIRITUALITY
RESPECT
INDEPENDENCE
RELATIONSHIPS
ENOYMENT

Achievement Point Prizes

*"I have run the race to the finish;
I have kept the faith"
(2 Timothy 4:7)*

ACHIEVEMENT

PRIZES

A pass to skip the lunch queue for one week	
Free time during a tutor session	
Sweets & Stationery Postcard from the Headteacher	

SAINT GEORGE CATHOLIC COLLEGE

This is in addition to being invited to the reward hour

Trinity:



A Year 9 boy with Autism and ADHD was asked "what should you do if you are having difficulties and you do not think people understand you?" He replied "Go to Trinity because there are people there to help you and they will help you."

Trinity is a brilliant part of our school. It is one of the first buildings you see when you enter the school grounds. This is another place that you can go to if you need some support for any reason. It is a safe and friendly place where you relax at break times, great for if you can't find your friends, feel a little overwhelmed, anxious or low. There are always friendly staff to speak to when needed.

Trinity is also somewhere you can go if you are struggling with your school work or have some worries to share. They run a homework club every day after school, as well as many other clubs to support you be a successful and confident learner.

Year 8 student asked: My parents think I may have Dyslexia as I find spelling, reading and writing really difficult. It can make me feel anxious about contributing at school, should I tell someone?
Answer: Yes, you definitely should! Any student with worries or concerns about anything should share them. They can talk to their tutor, Progress Leader or visit Trinity.

A Year 11 boy with Autism said "Trinity has helped to support me and helped me get back to class when I have difficulties. When I have felt stressed I have gone there to calm down so I can carry on my day. This is possible because of the kind staff who work there."

Our Neurodiversity Co-ordinator did an interview with some pupils who have Autism about St George and Trinity.

Q: If you had to give a new pupil some advice what would it be?

A: "Don't worry at all, I was nervous before but it's great!"

Q: If you feel that you are becoming stressed do you know what to do?

A: "I know I have a safe space in trinity, with things I like to help me calm down, and the staff after nice to me."

Q: Do you have any tips for pupils with Autism that you think might help?

A: "If you are getting the bus to school, either school bus or public transport then practice this route before your first day, and count how many stops there will be before you have to get off, and have a plan if you miss the bus or get off at the wrong stop."

Q: What do you think about Trinity?

A: "I am happy knowing I have trinity as an option, I like going there to calm myself down, and I enjoy learning social skills there too. When I am upset the Trinity staff look after me."

Lunch time:

For lunch, you have the choice to bring your own packed lunch or to buy a school lunch from the canteen. You can also buy snacks at break time. If you want to buy a school lunch, you do not need to bring money into school. You will have your fingerprint put onto the school system, and this is how you will pay for your food. Your parents can top up your account online, or you can put money into the machines at school. We have lots of food choices such as a main meal which could be a roast dinner, mac and cheese, curry etc. and we have jacket potatoes and pasta pots, and we have "quick food" like pizza slices, baguettes, wedges, cakes, fruit etc. Your parents will be able to see what you buy, so if you buy twenty cakes a day, they'll know!

During break and lunch time, Year 7s have their own sections. You'll be able to buy food and eat lunch in the main hall, and you can play on the MUGA. This means it's easier to make friends as all of the Year 7s will be in one place.



Lockers:

One of the biggest differences between secondary and primary school is that you no longer stay in the same classroom throughout the day, but instead have to go to different classrooms throughout the day. This means walking around with a lot in your bag. To make this easier, you can buy a locker (which will be located near to your tutor room) for the year to store your books, work and kit for subjects.

If you would like a locker, you need to pay a deposit of £10 for the year, which you will receive back at the end of the year. You also need to sign the locker agreement in your planner. This will be organised during your first week of school.

If you lose your locker key, you will lose the deposit as it will need to be replaced.



EduLink and MS Teams:

EduLink is an app you can get on your phone which allows you to see your timetable, attendance, behaviour points, house points and homework. It's a great way to keep organised and on top of things. Microsoft Teams is also a useful app to download as you'll have your classes on there so you can speak to teachers, look at assignments and read the Year 7 Teams page to get updates and news.



The school website:

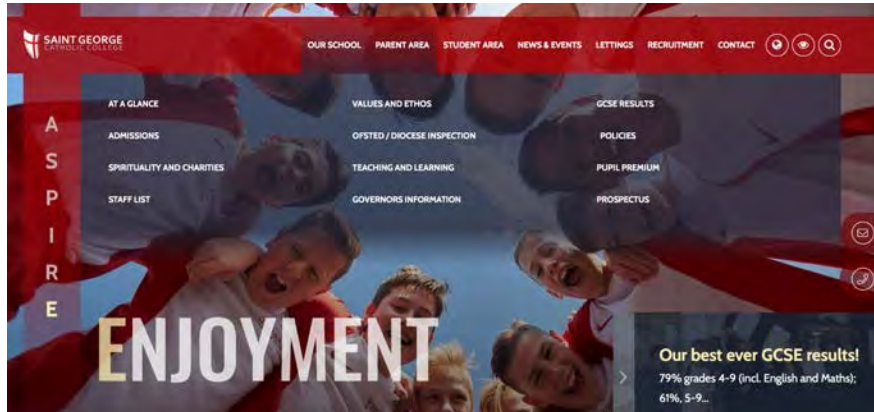

If you need any extra information about our school, you should find everything you need on our school website: www.stgcc.co.uk

FAQs:

Question: How is bullying dealt with?

Answer: Bullying is not common at St George. However, if it does happen, you must tell your tutor or a teacher. If you are worried about this and want to do this anonymously, we have forms in all of the tutor rooms that you can take to fill in when no one is in there, we also have a link on our computers to fill in this form online. Anyone found out to be bullying will face serious sanctions. Our anti-bullying policy can also be found in your planner.

Will I get lost?

You probably will in the first few weeks! But you will have a map with you in your planner, we have also put maps and signs around the school. You can also ask any of our friendly staff & students, if you cannot find anyone, ask at reception.

What if I miss my bus home?

You should not miss the bus as they do not leave until 3.10pm and teachers know not to keep students behind after school (unless it is a pre-arranged detention). This is enough time to get from your lesson to the bus stop. If you miss the bus due to a fault of your own, then we will make sure you are safe on the school site and call home for you.

Can I use my mobile phone in school?

No - we have a strict no phones policy. You can bring your phone into school in your bag, but it must be turned off. You may use your phone before you come onto the school site before 8.30am, or after 4pm. So you still cannot use it if you are on the school site from 3-4pm. If you need to call home, you must go to reception.

What if I feel sick?

If you feel sick at school, tell your teacher, and you will be able to go to the First Aid room. The nurse will help you, and if you are too sick to continue with the school day, they will ring your parents/guardians.

Can I ride my bike to school?

Yes you can, we encourage you to be environmentally friendly! We have a secure area for bikes where you can store your bike once you have got to school (you cannot ride it around the school site.) You must make sure you wear a helmet and have lights on your bike. You also need to follow the rules of the road very safely (we have assemblies on these to remind you.)

Will I be with my friends?

We cannot guarantee that you will be in a tutor group with all of your friends, but you will still see them a lot around school! You may be in classes with them but if not, you will definitely see them throughout the day, especially at break and lunch. Secondary school is a good opportunity to meet lots of new people and make friends.